



FOR LEASE

Multiple move in ready office suites are available for lease. All offices have gorgeous lake front views and ample on site parking. Windsor Lake is conveniently located near I-20, I-77, and Two Notch Road.

206: 168 SF office (12X14 ft) with private balcony overlooking the lake. Located on the second floor. The lease rate is \$350/month and includes everything except internet.

305: 3,250 SF private office suite located on the first floor. The office consists of 9 private offices, reception area, conference area, kitchenette, and plenty of room for storage. Offices have floor to ceiling glass windows to allow ample natural light. The lease rate is \$3,250/month and includes everything except internet.



DEMOGRAPHICS

	1 MILE	3 MILE	5 MILE
TOTAL POPULATION:	9,213	44,400	114,110
TOTAL HOUSEHOLDS:	3,956	18,651	42,139
MEDIAN HH INCOME:	\$37,550	\$45,205	\$51,528

Suite 305

WINDSOR LAKE

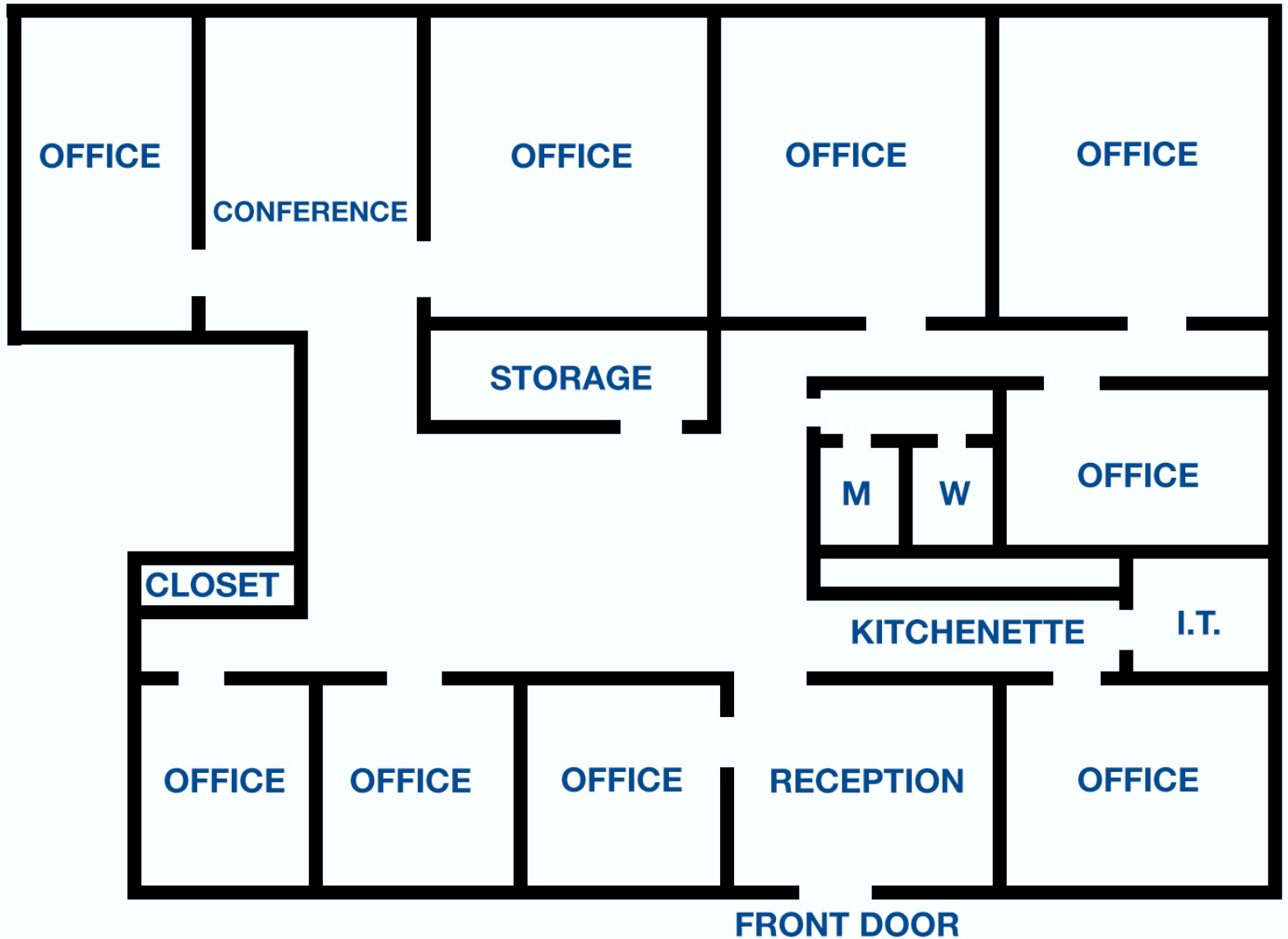

This floor plan is not drawn to scale